

2022 - ANNUAL REPORT

22 years of experience in applied decorative art in paediatric wards, specialised institutions, and homes for the elderly.

Paint a Smile





I had the pleasure of visiting the audiology unit of the HUG
- which was decorated by your artists -
with patients, their families, and with HUG staff.

A simple stroll down this decorated corridor is soothing, puts a smile on your face, and takes you away from the reality of the hospital for a while. A brief escape has its secrets, and I've seen for myself on several occasions how people react: there's a real beauty in their reactions, from the child who discovers a little bird in an examination cubicle to a senior doctor who finds a little peace by looking into the eyes of a beautiful cow on the wall.

A multiplication of these small daily pleasures will make an ocean of pleasure over time. Thank you for everything!

Professor Pascal Senn

*Head of the ENT and cervicofacial surgery department,
HUG (Geneva University Hospitals)*



A word from the President	p. 6
Portrait of the Foundation	p. 8
Our Colours Partner	p. 11
A Key Partner	p. 12
The Artist Painters	p. 14
Projects realised in 2022	p. 16
Events and Promotional Functions	p. 38
Organisational Structure and Management	p. 42
Auditors' Report	p. 44
2022 Figures	p. 45
2022 Balance sheet	p. 46
Operating account for the fiscal year	p. 47
Notes to the financial statements	p. 48
Acknowledgements	p. 50
Supporting our work	p. 51
2022 at a Glance	p. 52

Photo credits : © Marc Charbonnier, Jérôme Cousin, Matthieu Cousin, Dream Cars Day, Julien Grégorio for the Geneva University Hospitals (HUG), the Fribourgeois Hospital (HFR), Jean-Yves Lacôte, Martial Saunier for the Centre Hospitalier Alpes Léman (CHAL) and the Paint a Smile Foundation

Graphic design and layout: Oh comme c'est beau

Translation: roberta@grahamtranslation.com

September 2023



Dear Friends,

After two particularly complicated years hit by the pandemic, 2022 marked a return to greater normality in the Foundation's activities.

Five projects were completed by our talented artists, some of them having been with us for two decades.

Collectively, they were present for 536 days in hospitals and residential care facilities; their frescoes required almost 100 litres of paint and 33 m² of adhesive decoration.

As the Foundation has no financial resources of its own, it is thanks to donors and sponsors who support our projects that we are able to pursue our goal. A huge thank you goes out to them.

With its "Colourful Days" initiative, the Maison Caran d'Ache provided us with additional support in 2022; and I would like to take this opportunity to express my most sincere thanks to its President and CEO Carole Hubscher.

We plan to launch a new digital platform soon to raise awareness of our work and increase the visibility of our projects and our sponsors. I would like to thank all those who have supported this new digital direction.

Finally, I would like to thank our Director Claire Bulliard and our Project Manager Jérôme Cousin, who have

spared no effort in carrying out our projects and in fundraising throughout the year.

To all those who faithfully support us and to all the volunteers who help us in our mission, I would like to extend my most sincere gratitude.

Nicolas Killen
President



At the origin of the Paint a Smile Foundation, Laura Cotton, after a tragic accident, wanted to metamorphose the coldness of the hospital environment – often synonymous with hardship and loneliness – into a more colourful and positive world. In 2000 her wish was granted; the Paint a Smile Foundation was created, and its work recognised as being in the public interest. At yearend 2022, 208 projects have been carried out in 18 countries around the world.

Our objectives

- To create custom therapeutic designs that open the imagination and stimulate positive thoughts to better endure hospitalisations or stays in specialised institutions.
- To provide opportunities for caregivers to divert the attention of patients during medical procedures.
- To improve the reception of patients and their stay by means of soothing and interactive entertaining decorations, conducive to relaxation and good humour.

These benefits extend beyond patients and residents. They also touch their families, loved ones, and medical teams. They contribute to the Development Goals established by the UN.



The specificities

Medical establishments and specialised institutions have confidence in the Paint a Smile Foundation because of the rigor and professionalism with which it pursues its work.

Each decor is unique. Special care is given to the preparation and evaluation of these tailor-made projects. The themes are developed in collaboration with the medical teams, taking into consideration the environment of the premises, the treatment of pathologies and the diversity of persons received. This permanent dialogue with the medical profession is a real strength that allows our team to develop its know-how and to create therapeutic tools.

Paint a Smile collaborates with a dozen independent artist painters from various artistic backgrounds. They are specially trained to practice their art in a hospital setting.

Funding

To carry out its mission, the Paint a Smile Foundation must rely on the support of numerous partners and donors who share its vision and values. It pays particular attention to its expenditure and applies a policy of transparency in the use of donations. It is subject to the Federal Supervisory Authority (DFI). Its auditor is the Geneva-based fiduciary ECHO SA.





La Maison Caran d'Ache: colour to soothe and to stimulate

Since 2008, Caran d'Ache has provided the Foundation's artists with the paints they need to create murals in medical and social institutions.

This year, Caran d'Ache has gone one step further in its support for Paint a Smile with the "Colourful Days" campaign; from 25 to 28 November 2022, Caran d'Ache donated 20% of its sales profits to fund a Paint a Smile project at Geneva University Hospitals.

Because drawing and colour are a source of joy and soothing, the exceptional work carried out by the Paint a Smile teams is essential; and Caran d'Ache is honoured to support their work.

Carole Hubscher
President and Chief Executive Officer (CEO)

For over 100 years, Caran d'Ache has been making fine art and fine writing instruments with audacity and passion in its Geneva workshops, and in accordance with the Swiss Made label. Durable and of impeccable quality, they are designed to accompany everyone in the free and authentic expression of their creativity. To encourage moments of emotion, sharing, and happiness. To be a source of fulfilment, and to help all generations to see life in colour.

Cargill

Cargill International SA and its teams are proud and pleased to have supported Paint a Smile through numerous fundraising initiatives and partnerships since 2017:

BikeIT, every kilometre counts!

Employees take it in turns to ride for a maximum amount of time and kilometres as possible!

- 2017 Edition: CHF 2'970.-

Project supported: Connecting corridor between the geriatric wards and the reception area of the Hôpital de Loëx (Geneva University Hospitals)

- 2018 Edition: CHF 3'754.-

Project supported: Paediatrics department of the "Cité Générations" medical centre (Onex, Geneva)

- 2019 Edition: CHF 3'950.-

Project supported: Neonatology department of the Alpes Léman Hospital Centre (Contamine-sur-Arve, France)

"Escalade" Race

- 2018 Edition: CHF 2'590.- and 74 participants

Project supported: Paediatric orthopaedics department cast room at Geneva University Hospitals

- 2019 Edition: CHF 2'170.- and 62 participants

Project supported: Paediatric recovery room at La Tour Hospital in Meyrin (Geneva)

- 2022 Edition: CHF 1'645.- and 46 participants

Project supported: Decoration of the ENT and cervicofacial department (Part 2) at Geneva University Hospitals

Bycookies x Paint a Smile solidarity bike race

Two brave cyclists, José and Luis, covered 1,865 km in 7 days between Geneva and Porto. On this occasion, CHF 1,000 was donated for the Cargill logo printing on the riders' jerseys.

Project supported: Decoration of the ENT and cervicofacial department (Part 1) at Geneva University Hospitals

Cargill's 155,000 employees in 70 countries are committed daily to feeding the world in a safe, responsible, and sustainable way. Every day, we connect farmers with markets, customers with ingredients, and people and animals with the food they need. We combine 155 years of experience with new technologies to be the trusted partner of our customers in food, agriculture, finance, and industry sectors in more than 125 countries. Together, let's build a more sustainable future for agriculture.

Cargill has been based in Geneva since 1956 and employs over 350 people in grain and oilseed trading, shipping, financial activities, and risk management.





The work of Paint a Smile artists requires constant readjustments to adapt to each location and understand their identity, as much as to respond to the needs of patients, residents, and caregivers.

The work of professionals

The artists are all mandated professionals paid by Paint a Smile. They are of different nationalities and from various artistic backgrounds. A training period is guaranteed by the Foundation to ensure their ability to work for several weeks in unique and demanding environments.

On average, each artist works 13 weeks per year on projects located throughout the world. This regularity enables consistent improvement in the artistic quality and the therapeutic virtues of the decor.

Teamwork

The team is made up of model designers, colourists, graphic designers, and artist painters under the responsibility of a project manager. The synergy between all these human resources and their professional skills is essential to achieve our goals and renew our know-how. The Project Manager is in regular contact with the Director regarding the application of new working methods and the development of new communication media. Students in applied arts schools are often welcomed into the team, thus offering them the possibility of carrying out an internship in a medical environment.

An Essential Collaboration

Paint a Smile's activities fall within a very demanding framework. The quality of the decorations applied to the medical cause is the result of close collaboration with medical, educational, and administrative teams.

These moments of exchange are essential; the teams must have a thorough knowledge of the institution and its philosophy. Thus, the common objective is achieved: to contribute to quality treatments thanks to decorations that bring relaxation, comfort and tenderness in a context that can generate anxiety and withdrawal into oneself.

The artists

Jérôme Cousin

Project Manager

Maud André, Clément Chabert, Matthieu Cousin, Marie-Alix Hadacek and Dorothee Reynaud

Artistic Directors and Team Leaders

Lou Amoros-Augustin, Isabelle Aulas, Bastien Castres, Jess Francescato, Céleste Gangolphe, Quentin Jorand, Vincent Leclère, Florianne Mandin and Margot Mégier

Layout Designers and Artist painters





Location	Geneva, Switzerland
Department	ENT and cervicofacial department
Patients	Children and adults
Attendance	33,000 consultations annually
Theme	Centre for Audiology Research
Decorated areas	Corridor Audiometry booths (x 4) Screening room Vestibulometry
Project Duration	115 days
Team	5 artist painters

Funding



Department map / [Decorated areas](#)



Opposite and above: views of the corridor



The decoration

The design concept is to transform the department into a hearing research centre. Scientists, equipped with the latest technology, carry out observations on sound and listening to humans, animals, and the natural environment. In this way, the decor integrates visitors into a world that is close to reality, while offering them the chance to see things in a different, playful light.

On the right-hand side, the corridor features scenes that open onto nature: a countryside landscape with a garden section, offering a deep perspective on the surrounding area: woods, fields, etc. These bay windows immediately place this fictitious centre in a geographical environment that invites a certain tranquillity, a gentleness, the season evoked being that of a flowering spring.

On the left-hand side of the corridor, at each entrance to the audiometry booths and right up to the vestibulometry booth, the scenes directly evoke an experience based on sound.

The advantage of this design is that it reaches out to a wide range of people and makes certain medical procedures less dramatic. It offers a wide range of opportunities for patients, visitors, and nursing staff to talk to each other, while at the same time creating openings to the outside world.

On the left: detail of audiometry booth 2

On the right: corridor, left side



Testimonials

A big thank you for the work of the Paint a Smile team! The rendering is magnificent. The paintings brighten up our working days and fill our patients with wonder.

Pascale Six-Hof

Audiology Technician / Logistics Manager

The Paint a Smile team is very friendly. The result is superb, and the patients are very pleasantly surprised by this new decor.

Matilde

*Speech Therapist in the ENT department and CURIC
(French-speaking University Centre for Cochlear Implants)*

This new ENT department is so bright, welcoming, colourful, cheerful, and so very pleasant. One forgets everything just looking at these beautiful images. It's a real pleasure to work with such a friendly team.

Christine Roeder

You don't feel like you're in hospital anymore, it's great!

Emmanuelle

Mum

It's a really friendly place that makes you want to stay. Well done and thank you!

Eloan and his mum

The colours and beautiful images warm the hearts of children and parents alike. Well done!

Tristan and Vanessa

It's magnificent; the designed walls are soothing and reassuring. It makes the hospital seem more human. I'm hypersensitive and epileptic and when I saw the drawings I was delighted. What's more, they're very pretty. Well done artists.

Alexandre

Many thanks to the artists. The space is attractive, and the inside of the booths is pleasant. Thank you.

Himaya and his mum

Opposite: right side of the corridor



Media

- You Tube, HUG, Report "Hearing is not understanding: Auditory immersion at the HUG"
- HUG, www.hug.ch/actualite/service-dorl-chirurgie-cervico-faciale-fait-peau-neuve



Location	Contamine-sur-Arve, France
Department	Neonatology
Patients	New-born and premature babies
Attendance	400 patients annually
Theme	The Tree of Life
Decorated areas	Department entrances (x 2) Corridors (x 4) Office Rooms (x 8) Transfer chamber
Project Duration	136 days
Team	6 artist painters

Funding



Department map / Decorated areas



On the left: corridor no. 1 and office entrance

Above: detail of corridor no. 4, exit

On the right: detail of room 1307





The decoration

A world of abundant and varied trees is offered. The tree represents a powerful symbol; it grows, it matures, it flourishes. A theme that evokes a certain vitality, conducive to providing a positive environment for patients, relations, and staff. The multiplicity of foliage, bark, flowers, and fruit also highlight the beneficial and protective dimension of nature for mankind, and its soothing, restorative, and generous effects.

Within this natural environment, scenes have been developed around the lives of animals. They are deliberately simple, with no complex narrative, presenting a more contemplative and naturalistic point of view: that of the explorer who discovers, whose gaze is patient, curious, and attentive to everything new, echoing that of new parents. These images speak of family life, of everyday life, the aim also being to create a classic and reassuring framework evoking future moments to be discovered out of hospital.

On the left: Corridor 3

On the right: Office





Above: details of room 1308

On the right: exterior entrance to the department

Testimonials

We recently had the pleasure of admiring the pictorial frescoes created by your team in the heart of the Neonatology department at the Centre Hospitalier Alpes Léman.

The result is splendid. We'd like to take this opportunity to extend our warmest thanks to you and to all those who took part in this wonderful achievement, which brightens up the spaces and contributes directly to the well-being of families and professionals alike.

Didier Renaud
Director General

Doctor Jean-Sébastien Petit
Président of the CME

Over the past few weeks, I've enjoyed working in a department brought to life by artists from the Paint a Smile Foundation who, day after day, have known how to add colour to our daily lives. My team and I have appreciated their presence; and they have integrated perfectly into our working environment.

I was touched by one moment in particular; I saw a newborn baby in an incubator turn its head towards the artist painter who was creating a fresco in its room...

Anne Toupet
Health Executive, Paediatrics and Neonatology

The decorations are a great success and bring us comfort during this ordeal. They give a soul to the department.

Laura
Mum



Media

- CHAL, ch-alpes-leman.fr/inauguration-de-la-fresque-decorative-du-service-neonatalogie-du-chal

Location	Meyrin, Switzerland
Department	Paediatric intensive care unit
Patients	0 to 18 years
Attendance	16,381 consultations annually
Theme	Musical Siesta
Decorated areas	Ceiling Walls
Project Duration	20 days
Team	4 artist painters

Funding



The decoration

In the intensive care unit, young patients are confronted with two distinct moments: an intervention phase (care) and a waiting phase (recovery). During the first phase, the decoration is designed to entertain (play), while during the second it is more contemplative.

On the theme of a musical siesta, the fresco features a singer playing the harp on a membracidae (an insect with extravagant outgrowths). The characters around her enjoy the relaxing music.

This decoration offers a range of observation games: search and find, search and count, etc.



Testimonial

The Paint a Smile decorations on the walls of our paediatric ward help us in our daily work with the children.

When they come through the doors of our department, they are frightened to see our white coats, but as soon as they enter, we show them the drawings on the walls. This greatly reassures them, reduces their stress, and makes them less afraid for the rest of their treatment.

The drawings also help to distract the children while they're waiting. In the treatment room, the frescoes are very helpful to us; they divert the children's attention while we carry out the treatment. They're less apprehensive and less concerned about pain.

For me, the decorations in the paediatric wards are indispensable! Thank you to Paint a Smile for their work and their commitment to young patients!

Malaurie Thomas

Nurse

On the left: Detail of the ceiling

Opposite: Ceiling and wall of the resuscitation room



Location	Villars-sur-Glâne, Switzerland
Department	Paediatric Radiology
Patients	New-borns to adolescents
Attendance	2,000 patients annually
Theme	Maritime universe
Decorated areas	Entrance Reception Corridor Waiting Room Ultrasound room
Project Duration	80.5 days
Team	4 artist painters

Funding



Department map / Decorated areas

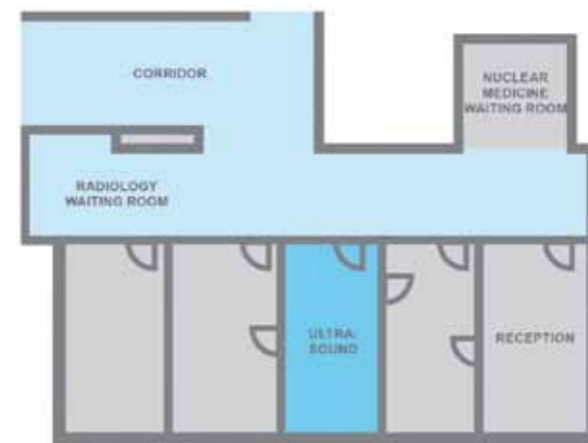

The decoration

The department is immersed in a maritime universe. The sea is a source of life, soothing to the eye; it is an element conducive to reflection and exploration. Various islets dot this expanse, offering a promise of travel and encounters, but also a chance to isolate oneself, reflect, and imagine. The sea also gives the department a strong visual unity and identity.

The scenes have been systematically imagined and placed with the aim of providing patients with appropriate support during their visit to the hospital:

Department entrance

Draw attention to the directional signage to make it easier to find your way around.

Reception

Enhance the visibility of the reception area.

Radiology waiting room

Create a reassuring and inspiring setting, with scenes that invite people to play and tell stories.

Ultrasound room

Reassure patients with a playful scene related to the examination.

On the right: department entrance

Following page: on the left: ultrasound room, and on the right: waiting room



Testimonials

Paint a Smile's work has transformed our department into a wonderful little world, soothing both young and older children, a positive factor in the success of an X-ray examination.

They discover and appreciate the painted scenes, like the fanciful birds decorating the ceiling of the ultrasound room; they are admired by all and allow them to dream.

These superb decorations provide children and parents an escape into an imaginary world, a way to play down the reason for their presence in this department and to enjoy a peaceful and relaxed moment.

More personally, when I arrive on the ward, these magnificent frescoes fill me with immense joy.

My warmest and most sincere thanks to Paint a Smile for your magnificent work.

Jasmin Hirsch-Delpy

Assistant Doctor in Paediatric Radiology

Now one can really see the area dedicated to children.

The decor is done with a lot of heart. It puts a big smile on our faces and makes us forget our fears.

Sophie

Mum

Media

- Fribourg Hospital, www.h-fr.ch/actualites-agenda/blog/hfr/la-radiologie-pediatrique-au-bord-de-la-mer



Location	Paris, France
Vehicle	Mobile Emergency and Resuscitation Service (SMUR) - Mobile Hospital Unit (UMH) n° 4014
Patients	0 to 17 years old
Attendance	1,200 annually
Theme	Space shuttle
Decorated areas	Rear patient compartment, interior
Project Duration	38 days
Team	4 artist painters

Funding

The decoration

The graphic approach is to transform the interior of the ambulance into the interior of a space shuttle.

The materials used in the ambulance and the medical equipment evoke a futuristic world. By integrating these very real elements into the decor, their frightening aspect is softened.

False windows have been created: through them, patients discover that the spaceship/ambulance is flying over a tropical island. These openings place patients and professionals in a positive environment that invites escape and daydreaming.

Inside the shuttle, there are many objects to discover. They bear witness to past journeys: souvenirs, postcards and knick-knacks decorate the cabin, giving it a cosy and comfortable feel.

The characters present are explorers and travellers, each going about their business during the flight from the cockpit to the back of the shuttle. Their uniforms evoke a certain professionalism: overalls, helmets, badges, etc.

The scenes provide plenty of opportunity for exchanges between the patient and the ambulance crew.

On the right: view of the technical platform housing the closed intensive care incubator





Testimonials

Distraction is the action of diverting the mind from a preoccupation. At the mobile paediatric emergency service (SMUR paediatric) we carry out an average of 1,200 transports a year. Over the years, we have realised that distraction during transportation can improve the way children are cared for.

The UMH ambulance - a mobile hospital unit - is a place of care that can be anxiety-provoking. The SMUR teams have been working for many years to prevent the management of pain and anxiety through several actions: parental presence, hypnoanalgesia, distraction by singing, presence of a tablet (showing films).

As in many paediatric services, we know that the care environment can have a positive impact on children's pain management and emotional well-being.

In 2022, we worked with the Paint a Smile Foundation to co-create a more humane ambulance.

After decorating our interior with stickers designed by the artists, we took an interest in how patients and their families felt about it. The feedback was extremely positive:

- A reassuring and comforting atmosphere
- An invitation for families to let go
- Improved management of pain and anxiety
- A tool for distraction and support for exchanges between patients and medical staff

On the left: view of the left-hand side

Thank you to the Paint a Smile team for this high-quality collaborative effort.

The SMUR Robert-Debré team

It's really great, we're almost sorry to leave you. It's reassuring to see this environment, it's true that it helps us feel better!

Parents

I want this in my room.

Fanta, 3 years old

It's the most beautiful truck in the world!

Ava, 4 years old

Wow, that's a really cool decoration!

Léo, 12 years old

Solidarity schools

Awareness raising and supporting initiatives

Involving the very young in philanthropic activities is essential for tomorrow. By instilling notions of solidarity and mutual aid from an early age, the solidarity schools help to turn today's children into tomorrow's caring, committed adults.

Mosaic School

Geneva, Switzerland

The Mosaic School Parents' Association organised several tea parties in favour of Paint a Smile. Thanks to these generous parents, CHF 832 was raised.



Le Rosey

Rolle, Switzerland

As part of their CAS (creativity, activity, service), the team of "Print a Smile" students created and sold sweatshirts in support of the decorations project in the general paediatrics department (children aged 0-3) at Geneva University Hospitals.

The "Sushi-n-Smile" team prepared and served an excellent Japanese dinner in support of the paediatric intensive care project at La Tour Hospital in Meyrin.

Well done and thank you for all your efforts!



Dream Cars Day

A solidarity event

The Dream Cars Day festival has been promoting car passion and sharing in the Gex region for 7 years. It brings together a team of big-hearted enthusiasts who work alongside associations to help children.

In 2022, €40,200 was raised, of which €3,500 was in favour of Paint a Smile.



Colourful Days

Solidarity purchase

From 25 to 28 November 2022, Caran d'Ache donated 20% of its profits from sales during these 4 days to the decorations project in the Ear, Nose and Throat (ENT) and Cervicofacial Surgery (CCF) departments of the University Hospitals (HUG) in Geneva.



The Colours Team

Solidarity Run (Geneva, Switzerland)

383 runners took part in this 15th edition of the run, in support of the ENT and CCF (Part 2) decor project at the HUG in Geneva.

CHF 9,200 was raised.



Foundation Board

The Board met four times during 2022. Composed of eight volunteer members, it defines the objectives and ethical guidelines to be pursued.

President

Nicolas Killen *, *Associate Lawyer, Borel & Barbey Law Firm*

Vice-President

Laura Cotton *, *Founder*

Secretary

Maya Page *, *Senior Legal Counsel, NS Partners SA*

Treasurer

Anne Elvire de Montjou *, *Consultant*

Director (not a Board member)

Claire Bulliard *

Members

Alexandre El Hage, *Doctor*

Patricia Leunis, *Store Design Planning and Visual Merchandising Manager, Cartier*

Deborah Najjar, *Art Mavens Director and Global President, Private Museums Network*

Satya Oblette, *Model*

* Collective signature of two persons

Management

The Foundation employs a director. She is in charge of administrative and financial management, fundraising, and the management of projects and various communication media.





REPORT OF THE REVIEW BODY ON LIMITED AUDIT
to the General Assembly of the
Paint a Smile Foundation, Geneva

As statutory auditors, we have audited the annual financial statements (balance sheet, operating account and annex) of the Paint a Smile Foundation for the financial year ending 31 December 2022.

Responsibility for the preparation of the annual accounts remains with the Foundation Board, while our task is to control these accounts. We certify that we meet the legal requirements for accreditation and independence.

Our control was carried out in accordance with the Swiss Standard for limited audit. This standard requires the planning and execution of the audit in such a way that significant anomalies in the annual accounts can be ascertained. The limited audit mainly covers hearings and analytical control operations, as well as appropriate detailed checks of the documents available in the monitored company. On the other hand, checks on operational flows and the internal control system as well as audits and other control operations to detect fraud or other violations of the law are not part of this control.

During our audit, we did not find any evidence to conclude that the annual accounts are not confirmed in accordance with the law and the articles of association.

Geneva, 20 June 2023

ECHO SA

Clémentine Largeteau
Certified Senior Auditor
(Lead Auditor)

Damien Moro
Certified Senior Auditor

Breakdown of expenses

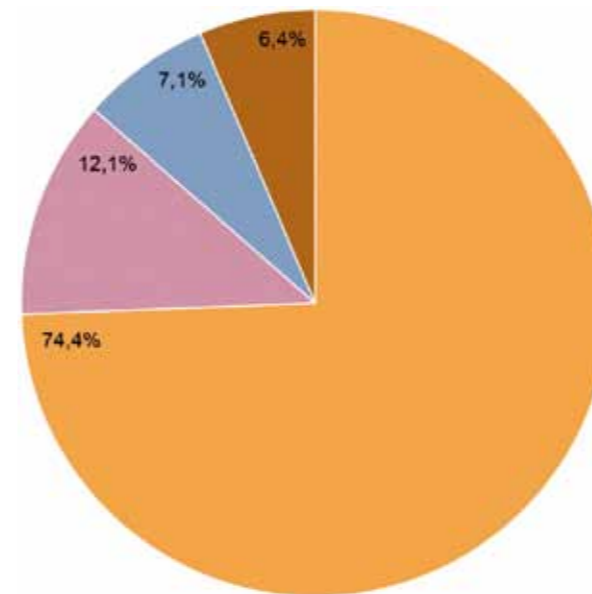

- Artistic performances & Project management
- Administration costs
- General costs, telephone, IT, communication, fundraising, amortisation fees
- Legal and fiduciary fees





BALANCE SHEET AS AT 31 DECEMBER, 2022		
	2022 CHF	2021 CHF
ASSETS		
Liquidity	152 914	185 697
Capital	331	-
Prepaid expenses attributed to 2023 projects	22 219	51 205
Accrued Assets	4 934	1 575
Current Assets	180 399	238 478
Net Tangible Fixed Assets	4 585	7 121
Fixed Assets	4 585	7 121
TOTAL ASSETS	184 984	245 599
LIABILITIES		
Creditors	3 477	1 157
Donations received in advance attributed to 2023 projects	113 427	165 317
Accrued Liabilities	10 000	8 500
Foreign Assets	126 905	174 974
Endowment capital	20 000	20 000
Voluntary Reserves from Profits	50 625	67 902
Results of the financial year	- 12 545	- 17 277
Equity	58 080	70 625
TOTAL LIABILITIES	184 984	245 599

PROFIT AND LOSS STATEMENT (For the period from 1 January through 31 December 2022)			
	Notes	2022 CHF (365 days)	2021 CHF (365 days)
Operating Income			
Donations	3	239 538	244 229
Total operating income		239 538	244 229
Operating Costs			
Staff expenses	5-6	65 019	74 282
Legal and fiduciary fees		15 912	17 154
Overhead costs, telephone, and IT		14 211	18 577
Artistic services	3	149 952	145 273
Travel, fundraising and hospitality costs		991	2 716
Amortisations		2 536	486
Total operating Costs		248 621	258 488
Operating Profit		- 9 083	- 14 259
Financial results			
Financial expenses		497	664
Exchange rate difference		3 012	2 372
Miscellaneous income		- 47	- 18
Total Operating Costs		3 462	3 018
Net income for the year		- 12 545	- 17 277





3. Supported projects

2022	CHF	2021	CHF
Generic donations	85 900	Generic donations	75 638
(1) HUG (Geneva) / ENT and Cervicofacial Department /. Project Fees	39 620 - 33 517 6 103	Communication /. Project Fees	15 000 16 725 - 1 725
La Tour Hospital (Geneva) / Paediatric consultations /. Project Fees	10 856 - 8 356 2 500	Saint Pierre Hospital / Paediatric Unit (Brussels) /. Project Fees	17 964 15 390 2 574
Royal Hospital (Oman) Paediatric Oncology Department /. Project Fees	39 022 - 34 997 4 025	Voix de l'Enfant / Beauvais Hospital Centre /. Project Fees	26 000 17 509 8 491
(2) Fribourg Hospital / Paediatric Radiology Department /. Project Fees	32 000 - 22 224 9 776	Fribourg Hospital / Neonatology Department /. Project Fees	17 900 14 348 3 552
Centre Hospitalier Alpes Léman (France) / Neonatology /. Project Fees	23 450 - 31 513 - 8 063	Geneva University Hospital / Paediatric orthopedic Unit /. Project Fees	44 437 32 906 11 531
Robert-Debré Hospital (Paris) / Paediatric SMUR /. Project Fees	8 690 - 10 578 - 1 889	Necker Hospital / Paediatric Cardiology /. Project Fees	47 291 39 692 7 600

(1) Donation from the Romande Lottery (Geneva) CHF 5 000
(2) Donation from the Romande Lottery (Fribourg) CHF 5 000

The project surplus does not take into account the operating and personnel costs, which are budgeted at 20 to 30%

5. Reduction of working hours (RHT)

	2022 CHF	2021 CHF
The foundation received RHT allowances	-	- 1 419

6. Staff costs

Details of "Staff costs":	65 019	74 282
Gross salary	55 200	55 200
/. RHT allowances	-	- 1 419
Adjustment of RHT allowances	-	2 675
AVS contributions	5 061	5 058
LPP contributions	4 260	12 136
LAA & IJM insurance	498	633

7. Review Body Fees

	2022 CHF	2021 CHF
Fees	3 328	3 328

8. Tax exemptions

The Foundation benefits from a tax exemption granted by the State Council of the Canton of Geneva in 2020. The exemption has been renewed for an indefinite period.

The supreme governing body of the Foundation certifies that the notes to the accounts are true and complete.



List of our donors in 2022

We express our profound gratitude to our partners and donors who, through their commitment and support, allow us to pursue our mission.

Colours partner



Key Partner



Foundations

- Fondation Alfred et Eugénie Baur
- Fondation des Hôpitaux de France
- Fondation Henri Cartier
- Fondation Étoile Filante

- Fondation pour la recherche et le traitement médical
- Fondation Rumsey-Cartier
- Fondation VRM
- The Pharos Trust
- The Rose Charitable Foundation

Associations, companies and donor groups

- Association Robert Debré
- Banque Reyl
- Bycookies
- Commune d'Anières
- Dream Cars Day
- École Mosaic

- Étude Borel & Barbey
 - Gonet & Cie SA
 - Institut Le Rosey
 - Kiwanis Fribourg
 - Loterie Romande (Fribourg)
 - Loterie Romande (Geneva)
 - Nestlé SA
 - NS Partners SA
 - Piguët Galland & Cie SA
 - Restaurant Le Lyrique
 - Symbiotics SA
- Private Donors
- Louise and Jonathan Cook
 - Robert-Debré Hospital private donors

We would also like to extend our warmest thanks to all those who volunteered their time: Noopur Ahuja, Philippe André, Anne-Laure Benardeau, Tanguy Bulliard, Louise Cook, Ariane Droin, Fabienne Jaquier, Alexander Killen and Luca Semino.



Paint a Smile is a member of La Voix De l'Enfant (The Voice of the Child), a federation of 82 associations operating in 103 countries with the aim of "listening to and defending all children in distress, wherever they may be".



Making a donation

As the Paint a Smile Foundation is recognised as being in the public interest, you can deduct your donation from your tax bill.

Tax exemption number

CH-660-2540000-9

Crédit Suisse

Account 1221433-21 (CHF)
IBAN CH30 0483 5122 1433 2100 0

Account 1221433-22 (EUR)
IBAN CH93 0483 5122 1433 2200 0

Postal Account

CCP 17-488126-1
IBAN CH84 0900 0000 1748 8126 1

Twint



Follow us on





2022 at a Glance

536 working days for artist painters
in hospitals, nursing homes
and specialized institutions

98,5 litres of paint

33 m² of adhesive decoration
And thousands of smiles...

With our colours partner since 2008

CARAN D'ACHE
Genève



Paint a Smile Foundation

2 rue de Jargonnant

CH - 1207 Geneva

T : + 41 22 735 91 25

welcome@paintasmile.org

www.paintasmile.org